

City of Waynesboro, Virginia

Tax Map: 64-10-2-18
Account Number: 414778

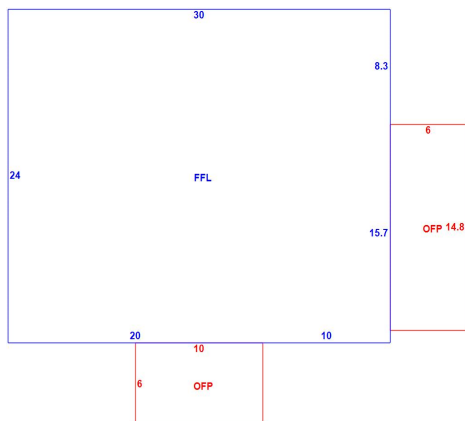

General Information

Owner Name	RAMSEY, ROBERT R & NEVERS, DONNA M
Owner Address	512 PINE AVE WAYNESBORO VA 22980
Property Address	108 VALLEY RD

Legal Description	BLOCK 2 LOT 18 RIVER SHORES
Other Description	60X120
Zoning Type	RS-7

Stormwater Impervious Surface

Parcel	Square Feet
64-10-2-18	1,034.11

Assessment Information

Assessment Year	2023
Building Value	\$107,600
Other Improvements	\$500
Total Land Value	\$40,000
Total Taxable Value	\$148,100

Other Improvements

Description	Unit(s)	Value
Storage Building	1	\$500
		Total Value
		\$500

Assessment History

Assessment Year	Building Value	Other Improvements	Total Land Value	Total Taxable Value
2023	\$107,600	\$500	\$40,000	\$148,100
2022	\$66,900	\$500	\$35,000	\$102,400
2021	\$75,100	\$500	\$35,000	\$110,600
2021	\$66,900	\$500	\$35,000	\$102,400
2020	\$43,900	\$500	\$35,000	\$79,400
2020	\$97,500	\$500	\$40,000	\$138,000
2019	\$44,400	\$	\$35,000	\$79,400
2017	\$33,300	\$	\$35,000	\$68,300
2015	\$32,400	\$	\$35,000	\$67,400
2013	\$35,100	\$	\$35,000	\$70,100
2011	\$40,800	\$	\$48,500	\$89,300
2009	\$47,500	\$	\$48,500	\$96,000
2007	\$45,700	\$	\$40,000	\$85,700
2005	\$36,600	\$	\$30,000	\$66,600
2003	\$35,300	\$	\$15,000	\$50,300

Dwelling: 1

Exterior Information

Year Built	1951
Occupancy Type	10
Foundation	Conc/Block
Ext. Walls	Brick
Ext. Walls 2	
Roofing	Comp Shingle
Roof Type	Gable
Garage	None
Garage - # Of Cars	
Built-In Garage - # of Cars:	
Carport	None
Carport - # Of Cars	0

Interior Information

Story Height	1
# of Rooms	4
# of Bedrooms	2
Full Bathrooms	1
Half Bathrooms	
Floors	Hardwood
Building SqFt	720
Basement SqFt	
Finished Basement SqFt	
Interior Walls	Plaster
Heating	Floor Furnace
A/C	None

Utilities

Water	Public Water
Sewer	Public Sewer
Electric	Yes
Gas	Yes
Fuel Type	Gas

Other Information

Fireplace	
Stacked Fireplace	
Flues	
Metal Flues	
Inop. Flues/Fire Place	
Gas Log Fireplaces	

Current Ownership Details

Name	Sale Date	Sale Price	Instrument	Plat Book/Page	Deed Book/Page	Will Book/Page
RAMSEY, ROBERT R & NEVERS, DONNA M	7/13/2016		WR 2016 100	0 / 0	/ 0	
RAMSEY, HETTIE P	1/1/1959	7,100	0 0	46 / 301	18 / 16	

City of Waynesboro, Virginia

Legend

- Railroads
- City Boundary
- _hiddenMajorRoads
- Streets
- Parcel Boundaries

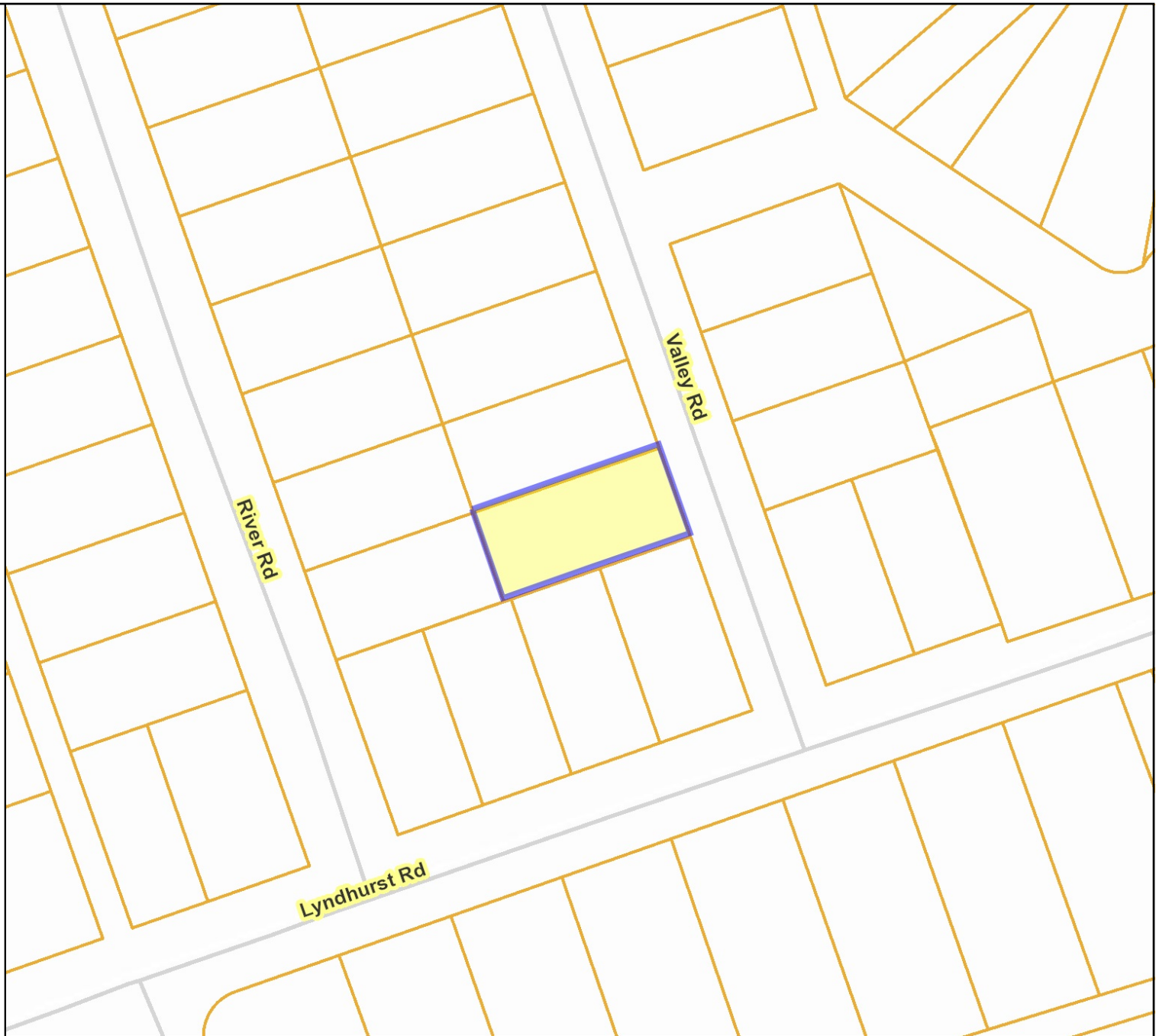

Map Printed from Waynesboro
<https://parcelviewer.geodecisions.com/Waynesboro>

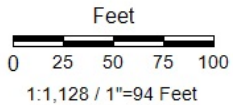

Title: Parcel Boundaries

Date: 5/14/2023

DISCLAIMER: This drawing is neither a legally recorded map nor a survey and is not intended to be used as such. The information displayed is a compilation of records, information, and data obtained from various sources, and City of Waynesboro is not responsible for its accuracy or how current it may be.