

# Real Estate Auction

113 Shutterlee Mill Lane  
Staunton, Va. 24401

Thursday, June 30, 2022 at 5:30 p.m

Great starter home or investment property. 3 bedroom, 1.5 bath home located in Augusta County. Includes a .1 acre lot in Staunton limits.

**OPEN HOUSE:** Sunday, June 12 from 2-4 p.m. and other times by appointment.

**Real Estate Terms:** Real Estate sold AS IS, WHERE IS without warranty of any kind. \$10,000 non-refundable bidders deposit required in the form of cash or cashier's check at conclusion of real estate auction. Balance due at closing on or about 45 days from auction. Announcements on day of sale take precedence over printed matter. Not responsible in case of accident. All items are offered "AS IS and WHERE IS." We make no warranties or guarantees, at any time, on an offered item or the description of that item. All bidders are encouraged to examine items before bidding.

## MARK W. CRAIG AUCTIONS

MARK W. CRAIG - Va. Lic. #2905002160 - 540/246-6430

Follow Us On the Web: [MarkCraigAuctions.com](http://MarkCraigAuctions.com)  
Follow Us On Facebook: Mark W. Craig Auctions

### Property Information - Tax Map# 045D 1 5 - Account# 0

Property Owner: Botkin, Eva K.	Legal Description: 45d-(1)-5 Shutterlee Village Port Lot 5 0.897 Ac	<a href="#">View Sketch (Building 1)</a>
Owners Address: 113 Shutterlee Mill Ln Staunton, Va 24401	Prior Assessment:	112,600 Zoned: Ga
Total Land Area: .897Acres	Assessment Values:	
Physical Location: 113 Shutterlee Mill Ln Staunton, Va 24401	<a href="#">Building 1</a>	73,671
Magisterial District: Pastures	<a href="#">Other Improvements:</a>	1,300
	<a href="#">Land Value:</a>	45,000
	Calculated Value:	119,971
	Rounded Taxable Value:	120,000

### Building Information - Building #1 - Tax Map# 045D 1 5

Exterior Information:	Interior Information:	Site Information:
Year Built: 1963	Story Height: 1.00	Zoning Type: Ga
Occupancy Type: Dwelling	# of Rooms: 6	Terrain Type: On
Foundation: Cinderblock	# of Bedrooms: 3	Character: Rolling/sloping
Ext. Walls: Vinyl	Full Bathrooms: 1	Right of Way: Public
Roofing: Comp Shg	Half Bathrooms: 1	Easements: Paved
Roof Type: Gable	Building Sq. Ft.: 1399	Water: Cistern
Garage: None	Basement Sq.Ft.: 894	Sewer: Septic
Carport: None	Fin. Bsmt Sq. Ft.: None	Electric: Yes
	Interior Walls: Drywall	Gas: No
	Floors: Wood	Fuel Type: Oil
	Carpet	Utility Value: 5000
	Heating: Flr. Fur.	Fireplace: None
	A/C: No	Stacked Fireplace: None
		Flues: 1
		Metal Flues: None
		Stacked Flues: None
		Inop Flue/FP: None
		Gas Log FP: None

**Other Improvements - Tax Map# 045D 1 5**

Description:	Parent Building:	Size in Sq. Ft.	Improvement Value - \$
Shed-frame	<a href="#">Building_1</a>	96	800
Pavement	<a href="#">Building_1</a>	N/A	500
Total Value:			\$ 1,300
Final Value Rounded to Nearest 100			

**Acreege Description - Tax Map# 045D 1 5**

Description	Size in Acres	Lump Sum/Per Acre	Unit Value	Adj. %	Utility Value	Acreege Value
Homesite	.897	Lump Sum	40,000	.00	5,000	45,000
Total Value:						\$ 45,000
						*rounded to the nearest 100

Sect	Type	Stories	SqFt
A	Main Structure	1.00	1399
B	Enclosed Porch	1.00	78
C	Porch	1.00	146

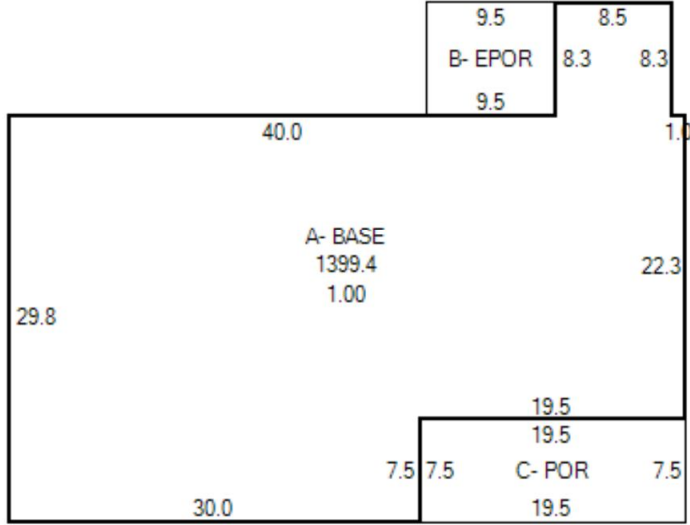

**Sales Information - Tax Map# 045D 1 5**

Name	Sales Date	Sales Price	Instrument	Grantor
Botkin, Eva K.	1/01/1973	\$500	Deed: 447 / 299	Not On File

**Transaction History:**

Botkin, Eva K.	1/01/1973	Not On File	Deed: 0 / Will: 0 /	045d 1 5
Botkin, Richard L. & Eva K.	1/01/1959	Not On File	Deed: 447 / 299 Will: 0 /	045d 1 5
Botkin, B. L. & Mabel C.	1/01/1947	Not On File	Deed: 348 / 9 Will: 0 /	045d 1 5
Botkin, Mabel C.	1/01/1947	Not On File	Deed: 0 / Will: 0 /	045d 1 5
Cline, S. Glenn	1/01/1946	Not On File	Deed: 345 / 103 Will: 346 / 405	045d 1 5
Silling, W. H.	1/01/1901	Not On File	Deed: 135 / 527 Will: 0 /	045d 1 5



## 1986 SHUTTERLEE MILL RD

[Sales](#)
[Print](#)
[Map It](#)

<b>Location</b>	1986 SHUTTERLEE MILL RD	<b>Acct#</b>	10539
<b>Owner</b>	SHEETS PEGGY B	<b>Assessment</b>	\$500
<b>PID</b>	10539	<b>Building Count</b>	1
<b>Legal Description</b>	LOT 5 (45D-1-5)-SPLIT PARCEL .101 CITY-CO DB 447/299	<b>Historic Dist</b>	
<b>Map Number</b>	143	<b>Zoning</b>	R1
		<b>Subdivision</b>	SHUTTERLEE VILLAGE

### Current Value

Assessment			
Valuation Year	Improvements	Land	Total
2022	\$0	\$500	\$500

### Owner of Record

<b>Owner</b>	SHEETS PEGGY B	<b>Sale Price</b>	\$0
<b>Co-Owner</b>		<b>Certificate</b>	
<b>Address</b>	113 SHUTTERLEE MILL LN STAUNTON, VA 24401	<b>Book &amp; Page</b>	220027273/0
		<b>Sale Date</b>	02/10/2022
		<b>Instrument</b>	03

### Ownership History

Ownership History					
Owner	Sale Price	Certificate	Book & Page	Instrument	Sale Date
SHEETS PEGGY B	\$0		220027273/0	03	02/10/2022
BOTKIN EVA K	\$0		0000/0001	04	01/01/1973

Land

Land Use		Land Line Valuation	
Use Code	401	Size (Acres)	0.10
Description	Res Land - LD	Frontage	
Zone	R1	Depth	
Neighborhood	SHTRLEE MILL	Assessed Value	\$500
Alt Land Appr Category	No		

Outbuildings

Outbuildings	Legend
No Data for Outbuildings	

Valuation History

Assessment			
Valuation Year	Improvements	Land	Total
2021	\$0	\$500	\$500
2020	\$0	\$500	\$500
2019	\$0	\$500	\$500

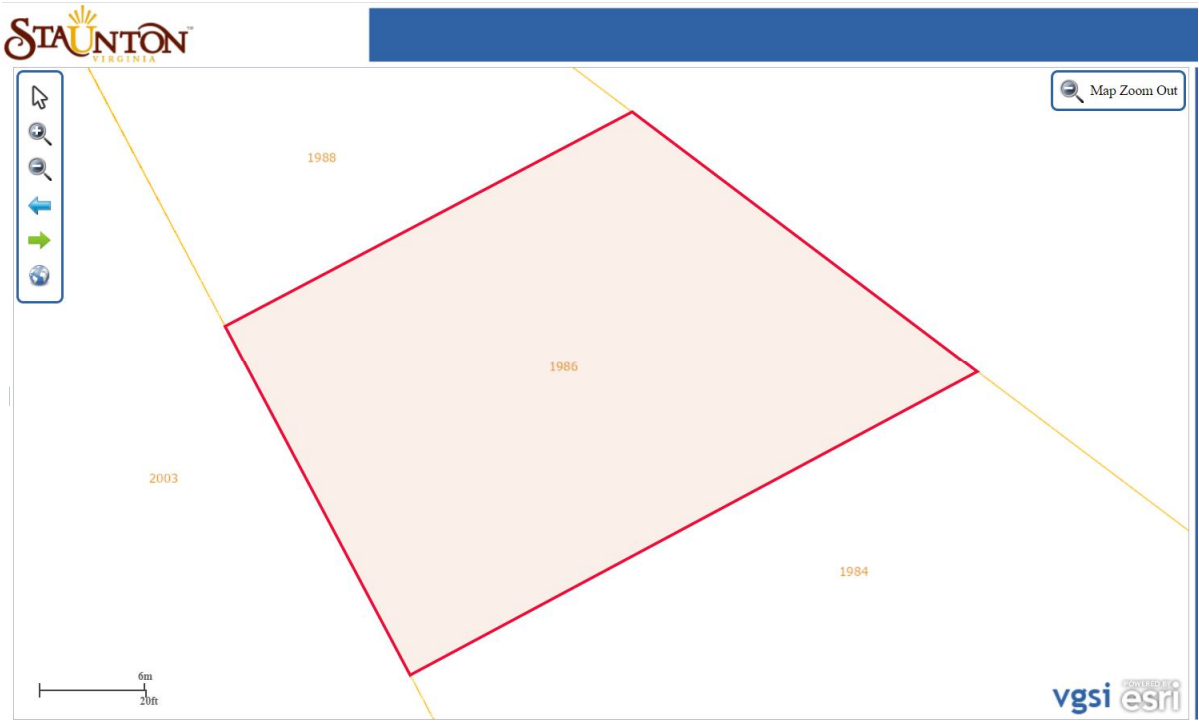

# Real Estate Auction

113 Shutterlee Mill Lane  
Staunton, Va. 24401

Thursday, June 30, 2022 at 5:30 p.m

Great starter home or investment property. 3 bedroom, 1.5 bath home located in Augusta County. Includes a .1 acre lot in Staunton limits.

**OPEN HOUSE:** Sunday, June 12 from 2-4 p.m. and other times by appointment.

**Real Estate Terms:** Real Estate sold AS IS, WHERE IS without warranty of any kind. \$10,000 non-refundable bidders deposit required in the form of cash or cashier's check at conclusion of real estate auction. Balance due at closing on or about 45 days from auction. Announcements on day of sale take precedence over printed matter. Not responsible in case of accident. All items are offered "AS IS and WHERE IS." We make no warranties or guarantees, at any time, on an offered item or the description of that item. All bidders are encouraged to examine items before bidding.

## MARK W. CRAIG AUCTIONS

MARK W. CRAIG - Va. Lic. #2905002160 - 540/246-6430

Follow Us On the Web: [MarkCraigAuctions.com](http://MarkCraigAuctions.com)  
Follow Us On Facebook: Mark W. Craig Auctions

### Property Information - Tax Map# 045D 1 5 - Account# 0

Property Owner: Botkin, Eva K.	Legal Description: 45d-(1)-5 Shutterlee Village Port Lot 5 0.897 Ac	<a href="#">View Sketch (Building 1)</a>
Owners Address: 113 Shutterlee Mill Ln Staunton, Va 24401	Prior Assessment:	112,600 Zoned: Ga
Total Land Area: .897Acres	Assessment Values:	
Physical Location: 113 Shutterlee Mill Ln Staunton, Va 24401	<a href="#">Building 1</a>	73,671
Magisterial District: Pastures	<a href="#">Other Improvements:</a>	1,300
	<a href="#">Land Value:</a>	45,000
	Calculated Value:	119,971
	Rounded Taxable Value:	120,000

### Building Information - Building #1 - Tax Map# 045D 1 5

Exterior Information:	Interior Information:	Site Information:
Year Built: 1963	Story Height: 1.00	Zoning Type: Ga
Occupancy Type: Dwelling	# of Rooms: 6	Terrain Type: On
Foundation: Cinderblock	# of Bedrooms: 3	Character: Rolling/sloping
Ext. Walls: Vinyl	Full Bathrooms: 1	Right of Way: Public
Roofing: Comp Shg	Half Bathrooms: 1	Easements: Paved
Roof Type: Gable	Building Sq. Ft.: 1399	Water: Cistern
Garage: None	Basement Sq.Ft.: 894	Sewer: Septic
Carport: None	Fin. Bsmt Sq. Ft.: None	Electric: Yes
	Interior Walls: Drywall	Gas: No
	Floors: Wood	Fuel Type: Oil
	Carpet	Utility Value: 5000
	Heating: Flr. Fur.	Fireplace: None
	A/C: No	Stacked Fireplace: None
		Flues: 1
		Metal Flues: None
		Stacked Flues: None
		Inop Flue/FP: None
		Gas Log FP: None



**Other Improvements - Tax Map# 045D 1 5**

Description:	Parent Building:	Size in Sq. Ft.	Improvement Value - \$
Shed-frame	<a href="#">Building_1</a>	96	800
Pavement	<a href="#">Building_1</a>	N/A	500
Total Value:			\$ 1,300
Final Value Rounded to Nearest 100			

**Acreege Description - Tax Map# 045D 1 5**

Description	Size in Acres	Lump Sum/Per Acre	Unit Value	Adj. %	Utility Value	Acreege Value
Homesite	.897	Lump Sum	40,000	.00	5,000	45,000
Total Value:						\$ 45,000
						*rounded to the nearest 100

Sect	Type	Stories	SqFt
A	Main Structure	1.00	1399
B	Enclosed Porch	1.00	78
C	Porch	1.00	146

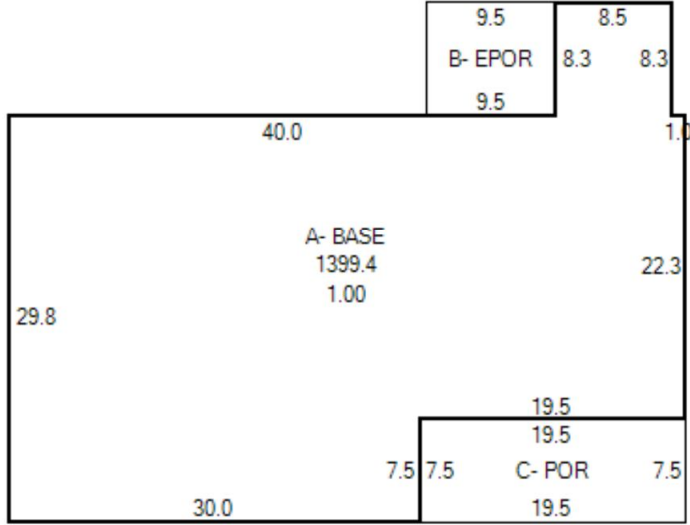

**Sales Information - Tax Map# 045D 1 5**

Name	Sales Date	Sales Price	Instrument	Grantor
Botkin, Eva K.	1/01/1973	\$500	Deed: 447 / 299	Not On File

**Transaction History:**

Botkin, Eva K.	1/01/1973	Not On File	Deed: 0 / Will: 0 /	045d 1 5
Botkin, Richard L. & Eva K.	1/01/1959	Not On File	Deed: 447 / 299 Will: 0 /	045d 1 5
Botkin, B. L. & Mabel C.	1/01/1947	Not On File	Deed: 348 / 9 Will: 0 /	045d 1 5
Botkin, Mabel C.	1/01/1947	Not On File	Deed: 0 / Will: 0 /	045d 1 5
Cline, S. Glenn	1/01/1946	Not On File	Deed: 345 / 103 Will: 346 / 405	045d 1 5
Silling, W. H.	1/01/1901	Not On File	Deed: 135 / 527 Will: 0 /	045d 1 5



## 1986 SHUTTERLEE MILL RD

[Sales](#)
[Print](#)
[Map It](#)

<b>Location</b>	1986 SHUTTERLEE MILL RD	<b>Acct#</b>	10539
<b>Owner</b>	SHEETS PEGGY B	<b>Assessment</b>	\$500
<b>PID</b>	10539	<b>Building Count</b>	1
<b>Legal Description</b>	LOT 5 (45D-1-5)-SPLIT PARCEL .101 CITY-CO DB 447/299	<b>Historic Dist</b>	
<b>Map Number</b>	143	<b>Zoning</b>	R1
		<b>Subdivision</b>	SHUTTERLEE VILLAGE

### Current Value

Assessment			
Valuation Year	Improvements	Land	Total
2022	\$0	\$500	\$500

### Owner of Record

<b>Owner</b>	SHEETS PEGGY B	<b>Sale Price</b>	\$0
<b>Co-Owner</b>		<b>Certificate</b>	
<b>Address</b>	113 SHUTTERLEE MILL LN STAUNTON, VA 24401	<b>Book &amp; Page</b>	220027273/0
		<b>Sale Date</b>	02/10/2022
		<b>Instrument</b>	03

### Ownership History

Ownership History					
Owner	Sale Price	Certificate	Book & Page	Instrument	Sale Date
SHEETS PEGGY B	\$0		220027273/0	03	02/10/2022
BOTKIN EVA K	\$0		0000/0001	04	01/01/1973

Land

Land Use		Land Line Valuation	
Use Code	401	Size (Acres)	0.10
Description	Res Land - LD ⓘ	Frontage	
Zone	R1	Depth	
Neighborhood	SHTRLEE MILL	Assessed Value	\$500
Alt Land Appr Category	No		

Outbuildings

Outbuildings	Legend
No Data for Outbuildings	

Valuation History

Assessment			
Valuation Year	Improvements	Land	Total
2021	\$0	\$500	\$500
2020	\$0	\$500	\$500
2019	\$0	\$500	\$500

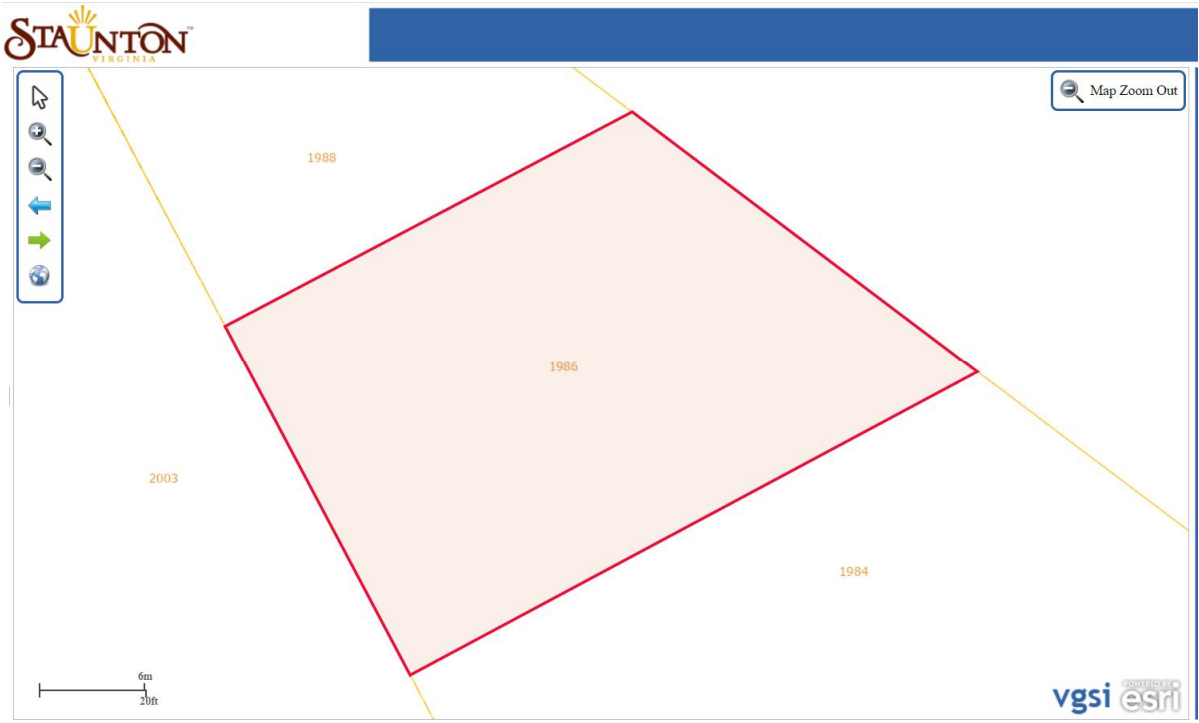



# Real Estate Auction

113 Shutterlee Mill Lane  
Staunton, Va. 24401

Thursday, June 30, 2022 at 5:30 p.m

Great starter home or investment property. 3 bedroom, 1.5 bath home located in Augusta County. Includes a .1 acre lot in Staunton limits.

**OPEN HOUSE:** Sunday, June 12 from 2-4 p.m. and other times by appointment.

**Real Estate Terms:** Real Estate sold AS IS, WHERE IS without warranty of any kind. \$10,000 non-refundable bidders deposit required in the form of cash or cashier's check at conclusion of real estate auction. Balance due at closing on or about 45 days from auction. Announcements on day of sale take precedence over printed matter. Not responsible in case of accident. All items are offered "AS IS and WHERE IS." We make no warranties or guarantees, at any time, on an offered item or the description of that item. All bidders are encouraged to examine items before bidding.

## MARK W. CRAIG AUCTIONS

MARK W. CRAIG - Va. Lic. #2905002160 - 540/246-6430

Follow Us On the Web: [MarkCraigAuctions.com](http://MarkCraigAuctions.com)  
Follow Us On Facebook: Mark W. Craig Auctions

### Property Information - Tax Map# 045D 1 5 - Account# 0

Property Owner: Botkin, Eva K.	Legal Description: 45d-(1)-5 Shutterlee Village Port Lot 5 0.897 Ac	<a href="#">View Sketch (Building 1)</a>
Owners Address: 113 Shutterlee Mill Ln Staunton, Va 24401	Prior Assessment:	112,600 Zoned: Ga
Total Land Area: .897Acres	Assessment Values:	
Physical Location: 113 Shutterlee Mill Ln Staunton, Va 24401	<a href="#">Building 1</a>	73,671
Magisterial District: Pastures	<a href="#">Other Improvements:</a>	1,300
	<a href="#">Land Value:</a>	45,000
	Calculated Value:	119,971
	Rounded Taxable Value:	120,000

### Building Information - Building #1 - Tax Map# 045D 1 5

Exterior Information:		Interior Information:		Site Information:	
Year Built:	1963	Story Height:	1.00	Zoning Type:	Ga
Occupancy Type:	Dwelling	# of Rooms:	6	Terrain Type:	On
Foundation:	Cinderblock	# of Bedrooms:	3	Character:	Rolling/sloping
Ext. Walls:	Vinyl	Full Bathrooms:	1	Right of Way:	Public
Roofing:	Comp Shg	Half Bathrooms:	1	Easements:	Paved
Roof Type:	Gable	Building Sq. Ft.:	1399	Water:	Cistern
Garage:	None	Basement Sq.Ft.:	894	Sewer:	Septic
Carport:	None	Fin. Bsmt Sq. Ft.:	None	Electric:	Yes
		Interior Walls:	Drywall	Gas:	No
		Floors:	Wood	Fuel Type:	Oil
			Carpet	Utility Value:	5000
		Heating:	Flr. Fur.	Fireplace:	None
		A/C:	No	Stacked Fireplace:	None
				Flues:	1
				Metal Flues:	None
				Stacked Flues:	None
				Inop Flue/FP:	None
				Gas Log FP:	None

**Other Improvements - Tax Map# 045D 1 5**

Description:	Parent Building:	Size in Sq. Ft.	Improvement Value - \$
Shed-frame	<a href="#">Building_1</a>	96	800
Pavement	<a href="#">Building_1</a>	N/A	500
Total Value:			\$ 1,300
Final Value Rounded to Nearest 100			

**Acreege Description - Tax Map# 045D 1 5**

Description	Size in Acres	Lump Sum/Per Acre	Unit Value	Adj. %	Utility Value	Acreege Value
Homesite	.897	Lump Sum	40,000	.00	5,000	45,000
Total Value:						\$ 45,000
						*rounded to the nearest 100

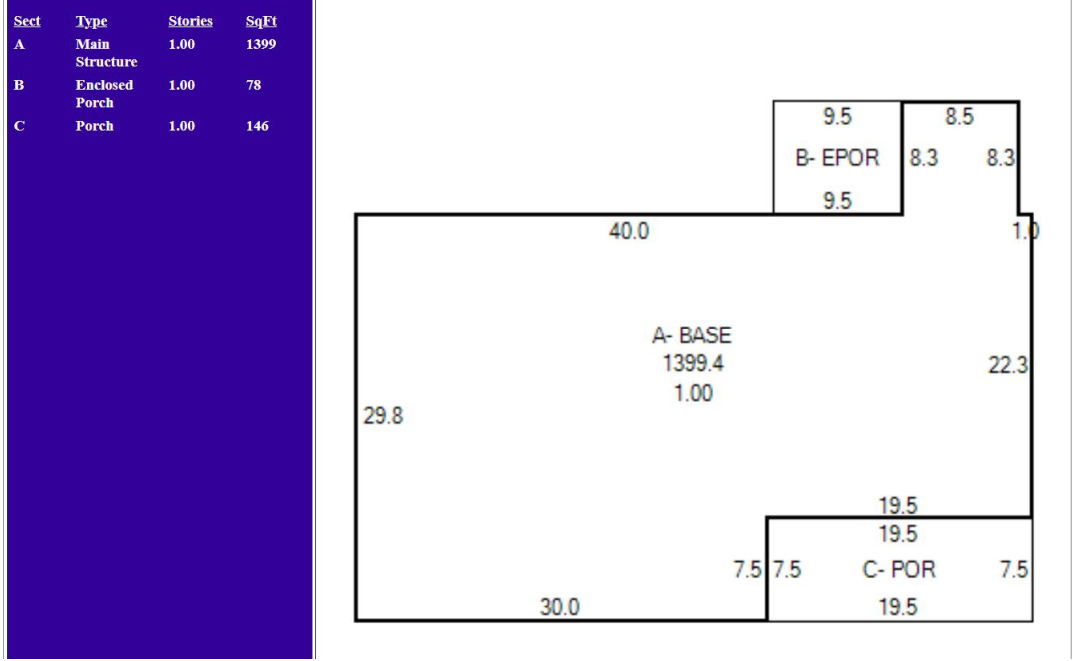

**Sales Information - Tax Map# 045D 1 5**

Name	Sales Date	Sales Price	Instrument	Grantor
Botkin, Eva K.	1/01/1973	\$500	Deed: 447 / 299	Not On File

**Transaction History:**

Botkin, Eva K.	1/01/1973	Not On File	Deed: 0 / Will: 0 /	045d 1 5
Botkin, Richard L. & Eva K.	1/01/1959	Not On File	Deed: 447 / 299 Will: 0 /	045d 1 5
Botkin, B. L. & Mabel C.	1/01/1947	Not On File	Deed: 348 / 9 Will: 0 /	045d 1 5
Botkin, Mabel C.	1/01/1947	Not On File	Deed: 0 / Will: 0 /	045d 1 5
Cline, S. Glenn	1/01/1946	Not On File	Deed: 345 / 103 Will: 346 / 405	045d 1 5
Silling, W. H.	1/01/1901	Not On File	Deed: 135 / 527 Will: 0 /	045d 1 5



## 1986 SHUTTERLEE MILL RD

[Sales](#)
[Print](#)
[Map It](#)

<b>Location</b>	1986 SHUTTERLEE MILL RD	<b>Acct#</b>	10539
<b>Owner</b>	SHEETS PEGGY B	<b>Assessment</b>	\$500
<b>PID</b>	10539	<b>Building Count</b>	1
<b>Legal Description</b>	LOT 5 (45D-1-5)-SPLIT PARCEL .101 CITY-CO DB 447/299	<b>Historic Dist</b>	
<b>Map Number</b>	143	<b>Zoning</b>	R1
		<b>Subdivision</b>	SHUTTERLEE VILLAGE

### Current Value

Assessment			
Valuation Year	Improvements	Land	Total
2022	\$0	\$500	\$500

### Owner of Record

<b>Owner</b>	SHEETS PEGGY B	<b>Sale Price</b>	\$0
<b>Co-Owner</b>		<b>Certificate</b>	
<b>Address</b>	113 SHUTTERLEE MILL LN STAUNTON, VA 24401	<b>Book &amp; Page</b>	220027273/0
		<b>Sale Date</b>	02/10/2022
		<b>Instrument</b>	03

### Ownership History

Ownership History					
Owner	Sale Price	Certificate	Book & Page	Instrument	Sale Date
SHEETS PEGGY B	\$0		220027273/0	03	02/10/2022
BOTKIN EVA K	\$0		0000/0001	04	01/01/1973

Land

Land Use

Use Code 401  
Description Res Land - LD ⓘ  
Zone R1  
Neighborhood SHTRLEE MILL  
Alt Land Appr No  
Category

Land Line Valuation

Size (Acres) 0.10  
Frontage  
Depth  
Assessed Value \$500

Outbuildings

Outbuildings	Legend
No Data for Outbuildings	

Valuation History

Assessment			
Valuation Year	Improvements	Land	Total
2021	\$0	\$500	\$500
2020	\$0	\$500	\$500
2019	\$0	\$500	\$500

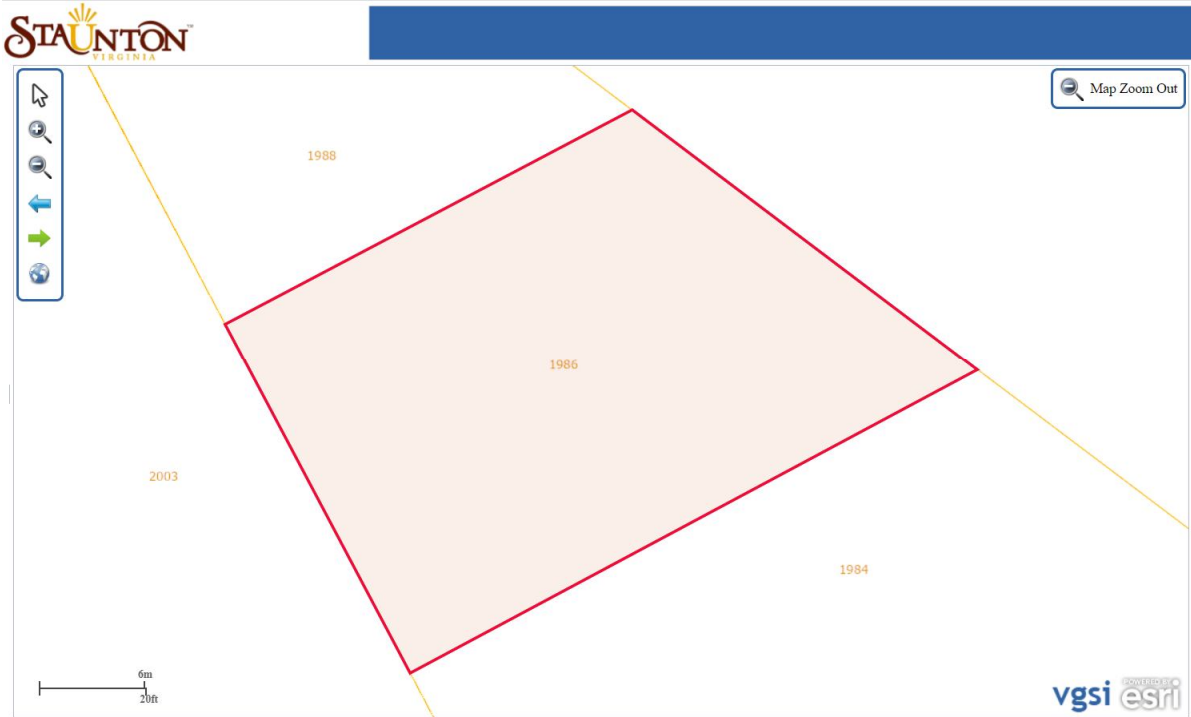

# Real Estate Auction

113 Shutterlee Mill Lane  
Staunton, Va. 24401

Thursday, June 30, 2022 at 5:30 p.m

Great starter home or investment property. 3 bedroom, 1.5 bath home located in Augusta County. Includes a .1 acre lot in Staunton limits.

**OPEN HOUSE:** Sunday, June 12 from 2-4 p.m. and other times by appointment.

**Real Estate Terms:** Real Estate sold AS IS, WHERE IS without warranty of any kind. \$10,000 non-refundable bidders deposit required in the form of cash or cashier's check at conclusion of real estate auction. Balance due at closing on or about 45 days from auction. Announcements on day of sale take precedence over printed matter. Not responsible in case of accident. All items are offered "AS IS and WHERE IS." We make no warranties or guarantees, at any time, on an offered item or the description of that item. All bidders are encouraged to examine items before bidding.

## MARK W. CRAIG AUCTIONS

MARK W. CRAIG - Va. Lic. #2905002160 - 540/246-6430

Follow Us On the Web: [MarkCraigAuctions.com](http://MarkCraigAuctions.com)  
Follow Us On Facebook: Mark W. Craig Auctions

### Property Information - Tax Map# 045D 1 5 - Account# 0

Property Owner: Botkin, Eva K.	Legal Description: 45d-(1)-5 Shutterlee Village Port Lot 5 0.897 Ac	<a href="#">View Sketch (Building 1)</a>
Owners Address: 113 Shutterlee Mill Ln Staunton, Va 24401	Prior Assessment:	112,600 Zoned: Ga
Total Land Area: .897Acres	Assessment Values:	
Physical Location: 113 Shutterlee Mill Ln Staunton, Va 24401	<a href="#">Building 1</a>	73,671
Magisterial District: Pastures	<a href="#">Other Improvements:</a>	1,300
	<a href="#">Land Value:</a>	45,000
	Calculated Value:	119,971
	Rounded Taxable Value:	120,000

### Building Information - Building #1 - Tax Map# 045D 1 5

Exterior Information:	Interior Information:	Site Information:
Year Built: 1963	Story Height: 1.00	Zoning Type: Ga
Occupancy Type: Dwelling	# of Rooms: 6	Terrain Type: On
Foundation: Cinderblock	# of Bedrooms: 3	Character: Rolling/sloping
Ext. Walls: Vinyl	Full Bathrooms: 1	Right of Way: Public
Roofing: Comp Shg	Half Bathrooms: 1	Easements: Paved
Roof Type: Gable	Building Sq. Ft.: 1399	Water: Cistern
Garage: None	Basement Sq.Ft.: 894	Sewer: Septic
Carport: None	Fin. Bsmt Sq. Ft.: None	Electric: Yes
	Interior Walls: Drywall	Gas: No
	Floors: Wood	Fuel Type: Oil
	Carpet	Utility Value: 5000
	Heating: Flr. Fur.	Fireplace: None
	A/C: No	Stacked Fireplace: None
		Flues: 1
		Metal Flues: None
		Stacked Flues: None
		Inop Flue/FP: None
		Gas Log FP: None



**Other Improvements - Tax Map# 045D 1 5**

Description:	Parent Building:	Size in Sq. Ft.	Improvement Value - \$
Shed-frame	<a href="#">Building_1</a>	96	800
Pavement	<a href="#">Building_1</a>	N/A	500
Total Value:			\$ 1,300
Final Value Rounded to Nearest 100			

**Acreege Description - Tax Map# 045D 1 5**

Description	Size in Acres	Lump Sum/Per Acre	Unit Value	Adj. %	Utility Value	Acreege Value
Homesite	.897	Lump Sum	40,000	.00	5,000	45,000
Total Value:						\$ 45,000
*rounded to the nearest 100						

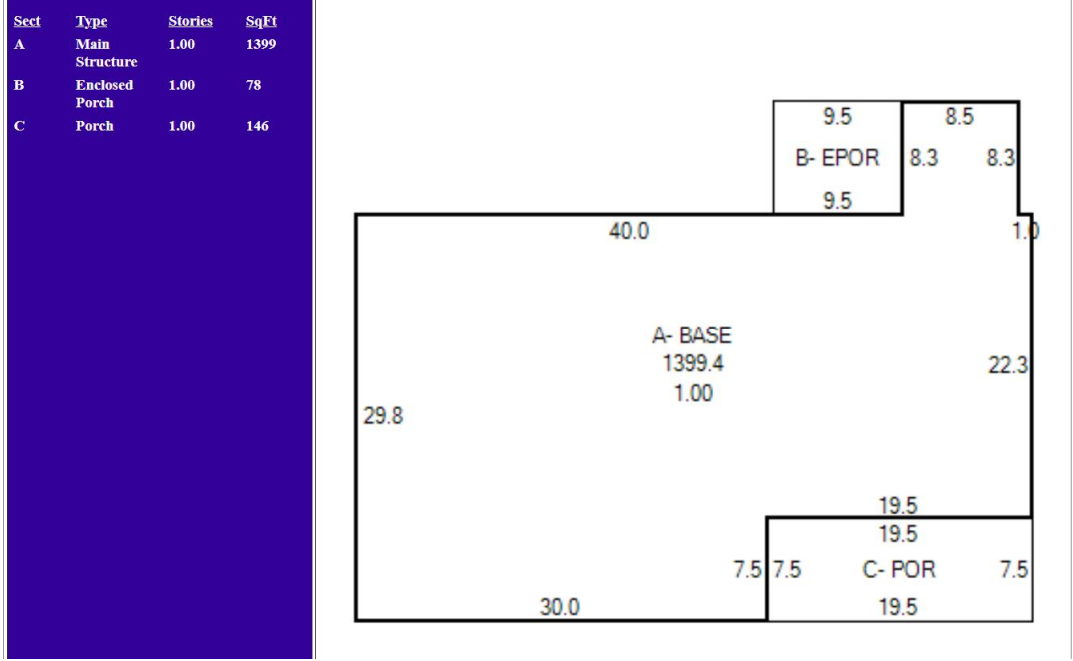

**Sales Information - Tax Map# 045D 1 5**

Name	Sales Date	Sales Price	Instrument	Grantor
Botkin, Eva K.	1/01/1973	\$500	Deed: 447 / 299	Not On File

**Transaction History:**

Botkin, Eva K.	1/01/1973	Not On File	Deed: 0 / Will: 0 /	045d 1 5
Botkin, Richard L. & Eva K.	1/01/1959	Not On File	Deed: 447 / 299 Will: 0 /	045d 1 5
Botkin, B. L. & Mabel C.	1/01/1947	Not On File	Deed: 348 / 9 Will: 0 /	045d 1 5
Botkin, Mabel C.	1/01/1947	Not On File	Deed: 0 / Will: 0 /	045d 1 5
Cline, S. Glenn	1/01/1946	Not On File	Deed: 345 / 103 Will: 346 / 405	045d 1 5
Silling, W. H.	1/01/1901	Not On File	Deed: 135 / 527 Will: 0 /	045d 1 5



## 1986 SHUTTERLEE MILL RD

[Sales](#)
[Print](#)
[Map It](#)

<b>Location</b>	1986 SHUTTERLEE MILL RD	<b>Acct#</b>	10539
<b>Owner</b>	SHEETS PEGGY B	<b>Assessment</b>	\$500
<b>PID</b>	10539	<b>Building Count</b>	1
<b>Legal Description</b>	LOT 5 (45D-1-5)-SPLIT PARCEL .101 CITY-CO DB 447/299	<b>Historic Dist</b>	
<b>Map Number</b>	143	<b>Zoning</b>	R1
		<b>Subdivision</b>	SHUTTERLEE VILLAGE

### Current Value

Assessment			
Valuation Year	Improvements	Land	Total
2022	\$0	\$500	\$500

### Owner of Record

<b>Owner</b>	SHEETS PEGGY B	<b>Sale Price</b>	\$0
<b>Co-Owner</b>		<b>Certificate</b>	
<b>Address</b>	113 SHUTTERLEE MILL LN STAUNTON, VA 24401	<b>Book &amp; Page</b>	220027273/0
		<b>Sale Date</b>	02/10/2022
		<b>Instrument</b>	03

### Ownership History

Ownership History					
Owner	Sale Price	Certificate	Book & Page	Instrument	Sale Date
SHEETS PEGGY B	\$0		220027273/0	03	02/10/2022
BOTKIN EVA K	\$0		0000/0001	04	01/01/1973

Land

Land Use

Use Code 401  
Description Res Land - LD ⓘ  
Zone R1  
Neighborhood SHTRLEE MILL  
Alt Land Appr No  
Category

Land Line Valuation

Size (Acres) 0.10  
Frontage  
Depth  
Assessed Value \$500

Outbuildings

Outbuildings	Legend
No Data for Outbuildings	

Valuation History

Assessment			
Valuation Year	Improvements	Land	Total
2021	\$0	\$500	\$500
2020	\$0	\$500	\$500
2019	\$0	\$500	\$500

